



WELCOME

HOT ISSUES IN HEALTH CONFERENCE

DECEMBER FIFTH AND SIXTH, TWO THOUSAND AND NINETEEN



THIS IS COLORADO'S **PREMIER** HEALTH POLICY FORUM.



WELCOME TO HOT ISSUES IN HEALTH.



Coordinating this conference each year is a significant undertaking that involves the careful orchestration of speakers, sponsors, technology, and timelines. At times it seems chaotic, but somehow, all the pieces fall into place. It's a lot like health policy in Colorado as we approach the 2020s. We can feel a lot of energy around innovations like the public option, payment reform, and community health purchasing alliances. But how do they all fit together? We'll explore that question over the next two days.

At the Colorado Health Institute, our goal is to ensure that policymaking is informed by sound evidence and analysis. We also know that policymaking works best when people at all levels of the system come together to share their knowledge. That's why this year we've increased the number of moderated panels on our agenda to bring in more viewpoints from across the state. We hope these diverse perspectives will challenge your thinking and inform your work.

We are honored to welcome our keynote and plenary speakers who will share national context, new research, and personal experiences. On Thursday, Dr. Jay Want of the Peterson Center on Healthcare will discuss ways of driving down health costs. Later that day, Denver resident and national headlining comedian Adam Cayton-Holland will share his story of loss and healing. On Friday, Stephen Hawkins of More in Common will address the perception gap and how the growing political divide affects policy. And PBS NewsHour White House correspondent Yamiche Alcindor will share the view from inside the Beltway, highlighting how the 2020 political campaigns will shape policy discussions.

Please join me in thanking our sponsors for their support, without which Hot Issues would not be possible. Our founding sponsor, Rose Community Foundation, helped to conceive this conference and has supported it from the beginning. Our presenting sponsor, SCL Health, has returned to provide crucial underwriting for this nonpartisan forum and supports Thursday's reception. We're also grateful to Platinum Sponsor COPIC; Silver Sponsors Colorado Health Foundation, Delta Dental of Colorado, and The Piton Foundation, part of Gary Community Investments; and Bronze Sponsors Cigna, Colorado Access, DaVita, and UnitedHealthCare.

Hot Issues in Health is a chance for us to step out of our day-to-day work and learn from one another. We can assess the progress we've made and look ahead at the forces that will shape health care and health policy in the year ahead. We encourage you to share what you know and where you're headed with your fellow conference attendees.

We're grateful to the elected officials and candidates joining us today. Your presence each year attests to your commitment to the health of all Coloradans. Finally, I am incredibly grateful to the CHI staffers who worked hard to create a program that explores the issues of the moment as well as the perennial forces and systems that drive health and health policy. They dedicate themselves throughout the year to rigorous research and analysis, and I am so proud of their work.



To your health,

A handwritten signature in black ink that reads "Michele Lueck".

Michele Lueck
President & CEO
Colorado Health Institute

FOR YOUR INFORMATION

HOTEL MAP

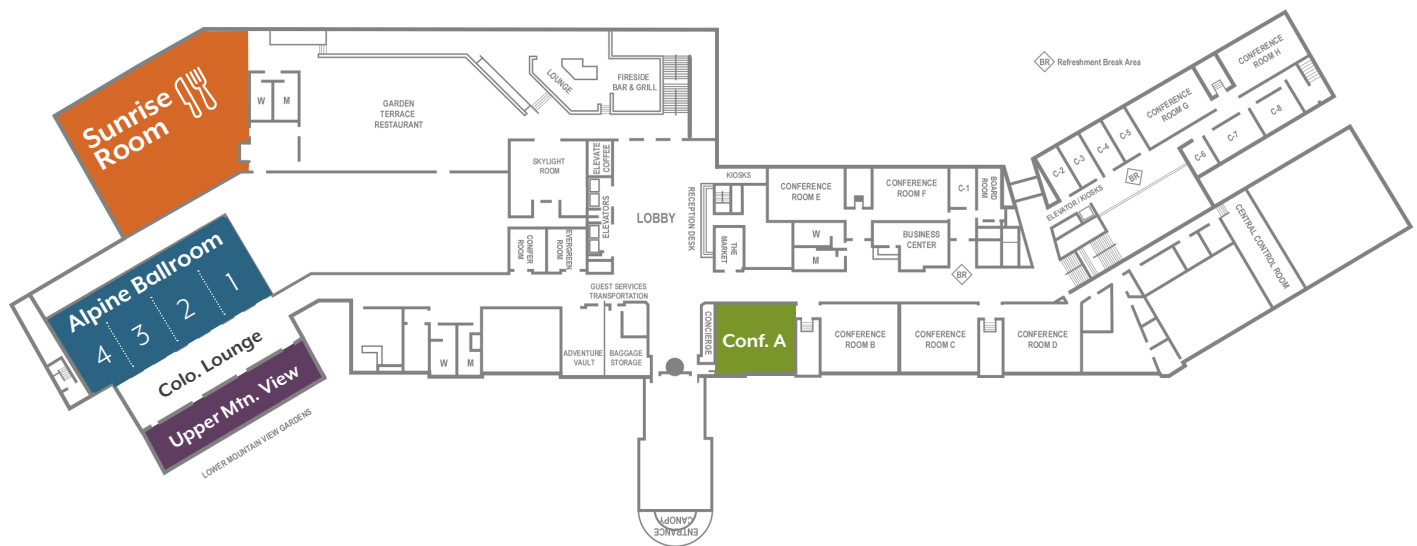

WIFI INSTRUCTIONS

Locate and connect to the network named Hilton Denver Inverness. You should be taken to a login page in your browser. Scroll down past sign-in and click on the Guest WiFi Connect button, then click “I have a promotional code.” Enter the code **hotissues2019**. Happy surfing!

LIVESTREAMING

We will be livestreaming portions of the conference for those who are unable to join us in person. Interested viewers may find the video stream on CHI’s website, coloradohealthinstitute.org.

TWITTER

Make sure you’re following CHI on Twitter at [@CoHealthInst](https://twitter.com/CoHealthInst) to keep up with all the Hot Issues action! We will be tweeting conference announcements, updates and other relevant information throughout both days. Be sure to use the official hashtag: **#HIHC19**.

BIKE DRAWING

We will continue our annual tradition of sending one of our attendees home with a new bicycle. Hot Issues attendees should receive two drawing tickets at registration, and everyone who attends the CHAS Results Rendezvous – the final session of Hot Issues – will receive one ticket. Presenters also have extra tickets to give away in their sessions, so participate fully and you might be rewarded! The drawing will take place at the conclusion of the CHAS session, and you must be present to win.

SPONSORSHIP



The Hot Issues in Health conference is made possible in part by funding and support from generous sponsor organizations.

The Colorado Health Institute acknowledges and thanks these sponsors, who exhibit a clear commitment to fostering productive policy conversations and moving the needle on important health and health care issues in Colorado through their financial support of the conference.

We extend our gratitude to the following organizations:



DAY ONE

- 7:30 A.M.**  **REGISTRATION AND BUFFET BREAKFAST**
Hallway outside Alpine Ballroom / Sunrise Room
- 8:30 A.M.**  **WELCOME**
Romana Hasnain-Wynia, CHI
Alpine Ballroom
- 8:35 A.M.**  **OPENING REMARKS**
Michele Lueck, CHI
Alpine Ballroom
- 9 A.M.**  **KEYNOTE ADDRESS**
Jay Want, Peterson Center on Healthcare
Introduction by Gerry Lewis Jenkins, COPIC
Alpine Ballroom
- 9:45 A.M.**  **BREAK**
- 10 A.M.**  **PANEL DISCUSSION**
REALIZING AFFORDABILITY: COLORADO'S PUBLIC OPTION AND OTHER INSURANCE INNOVATIONS
Moderator: Helen Drexler, Delta Dental of Colorado
Panelists: Michael Conway, Colorado Division of Insurance
Tom Donohoe, SCL Health
Amanda Massey, Colorado Association of Health Plans
Billy Wynne, Direct Health PBC
Alpine Ballroom
- 11 A.M.**  **2020 STATE LEGISLATIVE PREVIEW**
Joe Hanel and Allie Morgan, CHI
Introduction by Megan Mahncke, SCL Health
Alpine Ballroom
- 12 P.M.**  **BUFFET LUNCH AND NETWORKING**
Sunrise Room

You can find session descriptions on pages 10-11.

BREAKOUT SESSIONS ROUND ONE



1 P.M.

**The Cost of Doing Business:
What Employers Can Do to Address Rising Health Care Costs**
Conference Room A

Show Me the Money: Divvying Up Opioid Settlement Dollars
Alpine Ballroom II-III

Mission (Im)possible: Integration
Alpine Ballroom IV

Creating a Climate for Change: Navigating a Global Issue, Locally
Alpine Ballroom I

BREAK



2 P.M.

BREAKOUT SESSIONS ROUND TWO



2:15 P.M.

**The Cost of Doing Business:
What Employers Can Do to Address Rising Health Care Costs**
Conference Room A

Show Me the Money: Divvying Up Opioid Settlement Dollars
Alpine Ballroom I

Mission (Im)possible: Integration
Alpine Ballroom IV

Creating a Climate for Change: Navigating a Global Issue, Locally
Alpine Ballroom II-III

BREAK



3:15 P.M.

PLENARY ADDRESS



3:30 P.M.

Adam Cayton-Holland, Denver comedian and author
Introduction and post-session remarks by Romana Hasnain-Wynia
Alpine Ballroom

RECEPTION



4:15 P.M.

Sponsored by SCL Health
Includes book signing with Adam Cayton-Holland
Upper Mountain View and Colorado Lounge

DAY TWO

7:15 A.M.



REGISTRATION AND BUFFET BREAKFAST

Sunrise Room

8:30 A.M.



WELCOME REMARKS

Michele Lueck, CHI

Alpine Ballroom

8:45 A.M.



POLARIZATION AND DIVISION IN AMERICA TODAY

Stephen Hawkins, More in Common

Alpine Ballroom

9:30 A.M.



KEYNOTE ADDRESS

Yamiche Alcindor, PBS NewsHour White House Correspondent

Introduction by Lindy Eichenbaum Lent, Rose Community Foundation

Alpine Ballroom

10:30 A.M.



BREAK

10:45 A.M.



UPDATE FROM THE GOVERNOR'S OFFICE

Dianne Primavera, Colorado Lieutenant Governor

Alpine Ballroom

11:00 A.M.



ELECTED OFFICIALS AND CANDIDATES

Elected leaders and candidates have been invited to share updates on their health policy priorities and goals for the year ahead.

Andrew Romanoff (U.S. Senate candidate), confirmed

Fmr. Gov. John Hickenlooper (U.S. Senate candidate), unable to attend

U.S. Sen. Cory Gardner, unable to attend

Alpine Ballroom

You can find session descriptions on pages 12-13.

**PREVIEW: A STRATEGIC FRAMEWORK TO
IMPROVE BEHAVIORAL HEALTH IN DENVER**

Jalyn Ingalls, CHI
Alpine Ballroom



11:30 A.M.

LUNCH PICKUP AND NETWORKING



12:15 P.M.

**2019 COLORADO HEALTH ACCESS SURVEY
RESULTS RENDEZVOUS**

Jeff Bontrager and Eli Boone, CHI
Sunrise Room



12:45 P.M.

CLOSING REMARKS AND BIKE DRAWING

Sunrise Room



2 P.M.

DAY ONE SESSION DESCRIPTIONS

OPENING REMARKS

 Michele Lueck, President & CEO, CHI

KEYNOTE ADDRESS

 Jay Want, M.D., Executive Director, Peterson Center on Healthcare

The Polis administration's top health policy goal is to save people money. Dr. Want will discuss ways to drive down health care prices in Colorado and nationally through approaches ranging from policy and market dynamics to data and transparency.

REALIZING AFFORDABILITY: COLORADO'S PUBLIC OPTION AND OTHER INSURANCE INNOVATIONS

 Moderator: Helen Drexler, President & CEO, Delta Dental of Colorado

Panelists: Michael Conway, Colorado Insurance Commissioner; Tom Donohoe, Vice President and Deputy General Counsel, SCL Health; Amanda Massey, Executive Director, Colorado Association of Health Plans; and Billy Wynne, founder, Direct Health PBC

All eyes are on Colorado as the state becomes one of the first to launch a public option, at a time when many other new models and regulations are also taking shape. From the first year of the reinsurance program to insurance affordability standards, much is simultaneously in the works. State officials are describing Colorado's public option proposal as "transformative," but questions remain about how the recently released plan will be implemented and how it will intersect with other initiatives from the Division of Insurance. State legislators will consider how hospitals and insurers will be compelled to participate in the program and debate the merits of rate setting. We'll explore Colorado's shifting insurance landscape and the challenges and opportunities it brings.

SNEAK PREVIEW: THE 2020 STATE LEGISLATIVE SESSION

 Allie Morgan and Joe Hanel, CHI

Legislators typically shy away from tough policy debates in election years. But in 2020, they'll have to figure out how the plans they set in motion in 2019 — the state option, reinsurance, local purchasing alliances, and more — fit together. At the same time, pressure on the budget is growing, and the Polis administration isn't letting up on its push to lower health care prices. Our legislative preview sets the stage for the rest of the conference and the year ahead.

BREAKOUT SESSION

MISSION (IM)POSSIBLE: INTEGRATION

 Moderator: Sara Schmitt, CHI

Panelists: Michael Niyompong, Vice President of Strategic Community Partnerships, Mental Health Center of Denver; Neha Patel, Director of Care Delivery Transformation, Anthem; and Linda Reiner, Executive Vice President, Caring for Colorado Foundation

Integration has been a hot health policy topic for years, but the conversation has recently gone silent. Is integration out of style or is it simply too hard? We'll explore what integration truly means in health care (and for health) today, why it is so hard to achieve, who is succeeding, and what we can learn from their experiences.

BREAKOUT SESSION

CREATING A CLIMATE FOR CHANGE: NAVIGATING A GLOBAL ISSUE, LOCALLY

✍ Moderator: Karam Ahmad, CHI

Panelists: James Crooks, Ph.D., M.S., Associate Professor, Division of Biostatistics and Bioinformatics & Department of Biomedical Research, National Jewish Health; Jennifer Gremmert, Executive Director, Energy Outreach Colorado; Jill Hunsaker Ryan, Executive Director, Colorado Department of Public Health and Environment; and Cleave Simpson, General Manager of the Rio Grande Water Conservation District

Colorado has been on the vanguard of change when it comes to climate policy, but there's still much work ahead. We examine how climate connects to our health and explore how our communities can respond to this global issue.

BREAKOUT SESSION

THE COST OF DOING BUSINESS: WHAT EMPLOYERS CAN DO TO ADDRESS RISING HEALTH CARE COSTS

✍ Moderator: Ashlie Brown, CHI

Panelists: Tamara Pogue, MNM, CEO, Peak Health Alliance; Dave Ressler, CEO, Aspen Valley Hospital; and Laura Giocomo Rizzo, Senior Vice President of External Affairs, Denver Metro Chamber of Commerce

Colorado's employers pick up the bill for a large share of our health care costs. Join us as we explore what employers can do to make that bill more affordable — and what this could mean for the future of employer-sponsored insurance.

BREAKOUT SESSION

SHOW ME THE MONEY: DIVVYING UP OPIOID SETTLEMENT DOLLARS

✍ Moderator: Alex Caldwell, CHI

Panelists: Hilary Cooper, San Miguel County Commissioner, District 1; Dr. Robert Valuck, Director of the Colorado Consortium for Prescription Drug Abuse Prevention; and John Kefalas, Larimer County Commissioner, District 1 (1 p.m. session)/ Greg Poschman, Pitkin County Commissioner, District 3 (2:15 p.m. session)

The opioid crisis has sparked lawsuits across the country, and settlement dollars are likely to follow. With that money will come intense debate about how to spend it. Panelists will explore how communities can get ready now to make the best use of the funds.

PLENARY SPEAKER

✍ Adam Cayton-Holland, Comedian and Author

A national touring headliner and author of the acclaimed book *Tragedy Plus Time*, Cayton-Holland chronicles his childhood and his younger sister's suicide in what he describes as an "honest look at mental illness, depression, death, and the beautiful relationship between families and siblings — one that lets you know that there is no guide to grief, and that it's still OK to laugh."

DAY TWO SESSION DESCRIPTIONS

WELCOME

 Michele Lueck, President & CEO, CHI

POLARIZATION AND DIVISION IN AMERICA TODAY

 Stephen Hawkins, Director of Research, More in Common

What do individuals on either side of the political divide get wrong about their perceived opponents? Hawkins will highlight More in Common's research about this widening "perception gap" and how it applies to health care policy discussions and to politics in Colorado more broadly as we prepare for a consequential election year in 2020.

KEYNOTE ADDRESS

 Yamiche Alcindor, PBS NewsHour White House Correspondent

As the 2020 presidential campaign builds in intensity, candidates are shaping the national discussion about health policy. Alcindor will share the view from Washington and highlight the stories and experiences that have shaped her career as she covers both the decision-makers and the individuals impacted by their policy moves.

UPDATE FROM THE GOVERNOR'S OFFICE

 Dianne Primavera, Lieutenant Governor, State of Colorado

Lt. Governor Dianne Primavera, who leads Governor Polis' Office of Saving People Money on Health Care, will provide an update on the administration's work so far and its priorities for 2020.

REMARKS FROM ELECTED OFFICIALS AND CANDIDATES

Elected leaders and candidates have been invited to share updates on their health policy priorities and goals for the year ahead. As always, CHI does not endorse candidates or campaigns, but we strive to provide a platform for open dialogue.

ROAD TO WELLNESS: A STRATEGIC FRAMEWORK TO IMPROVE BEHAVIORAL HEALTH IN DENVER

 Jalyn Ingalls, CHI

As state and federal policymakers continue to debate the best ways to improve behavioral health, local communities are finding their own innovative ways forward. In Colorado, the *Road to Wellness: A Strategic Framework to Improve Behavioral Health in Denver* is an example of how many stakeholders can come together to identify needs and create an approach for improving behavioral health in their community. This conversation will highlight the political context, the values, and the financial considerations that informed the development of this new strategic framework in Denver.



BONUS EVENT!

2019 COLORADO HEALTH ACCESS SURVEY RESULTS RENDEZVOUS

 *Jeff Bontrager and Eli Boone, CHI*

Since 2009, the Colorado Health Access Survey (CHAS) has been the foremost source of data informing public policy on Coloradans' health, coverage, and care. When CHI shared six big headlines this fall, we listened to your most pressing questions and promised to dive deep into the data. We'll explore what the CHAS tells us about health coverage and access to care, the state's opioid crisis, the link between housing and health, and much more.

The Rendezvous features hosts Jeff Bontrager and Eli Boone unpacking the new data, and includes Friendly Feud, an unapologetic riff on America's favorite survey-based game show.

ATTENDEES WILL RECEIVE...



A printed copy of the 2019 Colorado Health Access Survey Storybook: Progress in Peril.



Boxed lunches provided by the Hilton Denver Inverness restaurant.



A ticket for entry into The Great Hot Issues Bicycle Giveaway — drawing begins immediately after CHAS Results Rendezvous.



2019 Colorado Health Access Survey results will be available online soon at colo.health/CHAS

FEATURED SPEAKERS



JAY WANT, M.D., is executive director of the Peterson Center on Healthcare. He leads the Center's expanding portfolio of initiatives and grants to identify high-performance models of health care, validate their impact on quality and cost, and facilitate their adoption on a national scale. Dr. Want brings decades of experience in health care delivery, improvement science, data transparency, and executive leadership.

Formerly chief medical officer and board chairman at the Center for Improving Value in Health Care, Dr. Want has expertise in creating public-private partnerships that support the transparency necessary for health care transformation. He has also consulted for the Network for Regional Healthcare Improvement, the Center for Medicare & Medicaid Services, and the Robert Wood Johnson Foundation.

Dr. Want has also served as an innovation advisor for the Center for Medicare & Medicaid Innovation and was the president and CEO of a management services organization that is now part of the Medicare Shared Savings ACO Program. He served on the board of the nonprofit Rocky Mountain Health Plan and on task forces for the Colorado Division of Insurance, The Colorado Trust, the Colorado Hospital Association, and the Governor's Blue Ribbon Commission on Health Care Reform.



ADAM CAYTON-HOLLAND is a national touring headliner who was named one of 25 "Comics to Watch" by Esquire magazine and one of "10 Comics to Watch" by Variety. Along with his cohorts in the The Grawlix comedy troupe, Cayton-Holland created, wrote and starred in truTV's "Those Who Can't," in which Cayton-Holland played Spanish teacher and bon vivant Loren Payton.

He has appeared on CONAN, The Late Late Show with James Corden, The Meltdown with Jonah and Kumail, Happy Endings, Deadbeat, Flophouse, Hidden America and @midnight. He has also been featured on WTF with Marc Maron, Nerdist, Comedy Bang Bang and Sklarbro County podcasts. Cayton-Holland has performed at the Montreal Just For Laughs, SXSW, and Bridgetown Comedy festivals, and helms his own comedy extravaganza in Denver, the High Plains Comedy Festival. He has also performed at The Kennedy Center and Carnegie Hall.

Cayton-Holland has three albums, "I Don't Know If I Happy," "Backyards," and "Adam Cayton-Holland Performs His Signature Bits," all available on iTunes. His first book, *Tragedy Plus Time*, was published by Touchstone Books in 2018. Cayton-Holland lives with his wife, Katie, his son, Malcolm, and a purebred Chesapeake Retriever named Annabel Lee.



STEPHEN HAWKINS leads More in Common’s studies to understand and address political polarization in the United States, France, Germany, and the United Kingdom. His reports with More in Common have been referenced in over 700 media articles, including in The New York Times, The Washington Post, The Economist, CNN, Fox News, and The Atlantic.

Hawkins has appeared on NPR, The Ben Shapiro Show, C-SPAN’s Washington Journal and recently spoke at the United Nations General Assembly. Prior to More in Common, Stephen advised on public opinion strategies for Fortune 100 companies such as Microsoft and Ford, and public sector organizations such as the Bill and Melinda Gates Foundation and the UN Refugee Agency. He received his master’s

degree in public policy from the Harvard Kennedy School of Government, and is curious about how beliefs define people’s experiences of the world.

Stephen lives in Denver with his fiancée and enjoys snowboarding in the Rocky Mountains and performing impersonations of American political figures.



YAMICHE ALCINDOR is the White House correspondent for PBS NewsHour and a political contributor for NBC News and MSNBC. At PBS NewsHour, she has directly questioned President Trump a number of times and has traveled extensively, including to places like Belgium for the 2018 North Atlantic Treaty Organization meeting, to Helsinki, Finland, as President Trump met with Russian President Vladimir Putin, and to McAllen, Texas, to chronicle life on the border of the United States and Mexico and the impact of President Trump’s family separation policy.

As a contributor for NBC News and MSNBC, Alcindor often appears on shows, including Morning Joe, Andrea Mitchell Reports, Hardball with Chris Matthews, and Meet the Press with Chuck Todd. Previously, she was a national reporter for The New York Times, covering politics and social issues, and a reporter with USA Today.

She was named “Emerging Journalist of the Year” in 2013 by the National Association of Black Journalists. Alcindor earned a master’s degree in broadcast news and documentary filmmaking from New York University and a bachelor’s in English, government and African American studies from Georgetown University.

SPEAKERS AND PANELISTS

PANEL: WHAT INSURANCE INITIATIVES, INCLUDING THE PUBLIC OPTION, MEAN FOR CONSUMERS AND AFFORDABILITY



MICHAEL CONWAY was appointed as Colorado Insurance Commissioner by Gov. Jared Polis on December 21, 2018, and was confirmed to this position by the Colorado State Senate on January 22, 2019. Prior to this,

Conway served as interim commissioner, a position he was appointed to by Gov. John Hickenlooper in January 2018. As commissioner, Conway serves as the chief executive of the Division of Insurance and oversees the regulation of the insurance industry in Colorado. His role brings together consumers, the insurance industry, and other stakeholders to create an inclusive, firm, and fair regulatory approach to all lines of insurance.



TOM DONOHOE is vice president and deputy general counsel for SCL Health. In his role, Donohoe provides primary legal support and advice on system-wide transactional matters, corporate governance and state advocacy. He also serves as lead

operations counsel for SCL Health hospitals located in the Front Range. Prior to this role, he was Denver office managing partner for Hall, Render, Killian, Heath & Lyman, a national law firm that specializes in health law. He serves as chair of the Colorado Bar Association Health Law Section and co-chair of the Association of Corporate Counsel – Colorado Chapter Health Law Section.



HELEN DREXLER is president and CEO of Delta Dental of Colorado. With more than 30 years of progressive management experience, Drexler is deeply versed in all aspects of the health insurance industry. She supported

operations, strategic planning, organizational development, and marketing during two national acquisitions and led a national system migration during Y2K. She has vast experience in provider contracting, having led the development of several managed care networks in the early 1990s. Drexler is a community leader who believes businesses see the greatest success when they help to strengthen the communities they serve.



AMANDA MASSEY was appointed Executive Director of the Colorado Association of Health Plans in February 2019. Massey has spent her career in health care, previously serving as director of member services at the Medical Group Management

Association. Massey holds a Graduate Certificate in International Marketing from Boston University, a master's degree in political strategy and communication from the University of Kent, and a bachelor's degree in international affairs from the University of Colorado at Boulder.



BILLY WYNNE is the founder of Direct Health, a public benefit corporation established to design state public option solutions that meet the needs of local communities. He is also the CEO of the Wynne Health Group, one of Washington's leading health care policy and advocacy firms. From 2006 to 2008, Billy served as Health Policy Counsel to the Senate Finance Committee, where he was a key drafter and negotiator of several health care laws and assisted in the development of the health care reform white paper that served as the basis for the Affordable Care Act.

CREATING A CLIMATE FOR CHANGE: NAVIGATING A GLOBAL ISSUE, LOCALLY



JAMES CROOKS, PhD, MS, is an environmental epidemiologist and statistician at National Jewish Health and at the Colorado School of Public Health. Prior to moving to Denver in 2015, he worked for seven years as a scientist in the

U.S. Environmental Protection Agency. His research addresses health effects of air pollution with a focus on climate-sensitive extreme events such as wildfires and dust storms. He co-directs the Program on Environmental Epigenetics at National Jewish Health and leads the Respiratory Disease and Air Pollution working group at the Colorado Consortium for Climate Change and Health.



JENNIFER GREMMERT has served as executive director at Energy Outreach Colorado (EOC) since January 2018. She has more than 20 years of nonprofit leadership experience and previously served as EOC's deputy director since 2003.

She has worked for many years with statewide partners to improve the quality of life for low-income households and ensure that they can remain safely and comfortably in their homes



JILL HUNSAKER RYAN, MPH, is a public health professional with more than two decades of experience in the field. Most recently, she was a two-term Eagle County commissioner where she focused her efforts on affordable health care,

environmental protection, climate action, emergency preparedness and increasing mental health resources. She also served as president of Colorado Communities for Climate Action and as manager of the Eagle County Public Health agency. She was a previous director of the Colorado Department of Public Health and Environment Office of Health Disparities, now called the Office of Health Equity, and was a governor's appointee to the state Board of Health.



CLEAVE SIMPSON is a fourth-generation San Luis Valley farmer and rancher who serves as the general manager of the Rio Grande Water Conservation District and on the Adams State University Board of Trustees. He serves as a representative on the

Rio Grande Basin Roundtable and is a roundtable representative to the statewide Interbasin Compact Committee. He also is active in the Colorado Water Congress and has served on the Farm Service Agency County Committee, Alamosa County Planning Commission, Alamosa Mosquito Control District, and Alamosa School District Accountability Committee. He is currently a candidate for the Colorado State Senate.

HOT ISSUES FURTHER READING: **CLIMATE AND HEALTH**

As of early 2019, just 26 of Colorado's 64 counties had at least some level of government action to address climate change (such as local public health priority plans or county or city climate plans).

Policymakers and the public can use CHI's Health and Climate Index to craft local responses to this global issue: colo.health/ClimateIndex

SPEAKERS AND PANELISTS (CONT.)

MISSION (IM)POSSIBLE: DESTINATION INTEGRATION



MICHAEL NIYOMPONG, MBA, MS, is vice president of strategic community partnerships at the Mental Health Center of Denver (MHCD). He is responsible for establishing and facilitating new cross-sector partnerships

that comprehensively and creatively meet the mental health and related well-being needs of the community. Prior to joining MHCD, Niyompong was chief operating officer at Denver-based Clayton Early Learning. He was also vice president at Rebound Solutions, a socially conscious firm specializing in strategy, change management, and turnaround solutions, and was vice president of technology and facilities at Mile High United Way.



NEHA PATEL is a Licensed Professional Counselor (LPC) receiving her masters in counseling psychology from the University of Denver. She also holds a masters in management from Colorado State University.

Patel has worked as a therapist in a variety of roles, including private practice, inpatient and residential settings, community mental health centers, including three years at Denver Children's Home. Currently, she is the Director of Community Transformation for the Southeast Region for the Enhanced Personal Health Care (EPHC) Program at Anthem. The EPHC program focuses on improving value-based care within care delivery systems in health care.



LINDA REINER serves as the executive vice president at Caring for Colorado, an organization she has worked with since 2001. In her current role, Reiner works with Caring for Colorado's president, board and staff to set the strategic

direction of the organization and to support staff in actualizing Caring for Colorado's mission. Over the years, Reiner has helped to create several Caring for Colorado initiatives and foundation funding collaboratives, including Advancing Colorado's Mental Health Care, Cavity Free at Three, and the SMILES Dental Project. Prior to joining Caring for Colorado, Reiner worked for Tri-County Health Department.

HOT ISSUES FURTHER READING: **USE OF CARE**

More Colorado residents than ever report having a usual source of care (87.6 percent), and nearly three in four (74.0 percent) got preventative care in the past year, an increase from 62.4 percent in 2017.

Learn more here: colo.health/CHAS

SHOW ME THE MONEY! DIVVYING UP OPIOID SETTLEMENT DOLLARS



HILARY COOPER is a first-term county commissioner in San Miguel County. Cooper was elected with a background in natural resource issues, but quickly recognized the need to address the affordability and accessibility

of health care for her constituents. Cooper sees her role as one of problem solver and greatly appreciates this conference and CHI for providing the crucial research and information needed to enable good decisions.



JOHN KEFALAS is the Larimer County Commissioner representing District 1. He is a former Democratic member of the Colorado State Senate, representing District 14 from 2013 to 2019. Kefalas served in the Colorado House of

Representatives, representing District 52. from 2007 to 2013. He has worked as a public policy advocate with Catholic Charities Archdiocese of Denver, as an adviser to Project Self-Sufficiency, Fort Collins/Loveland, as an employment counselor at Larimer County Employment and Training Services, and as the director of the Tax Fairness Project of the Colorado Progressive Coalition.



GREG POSCHMAN is the Pitkin County Commissioner for District 3. Prior to his term as a Pitkin County Commissioner, he photographed and directed television documentaries on subjects ranging from wildlife,

adventures, and river expeditions to music biographies and humanitarian crises on locations around the world. He was awarded three national Emmy awards for directing and camerawork. He was an active board member in the Aspen community for environmental and historical organizations prior to being elected in 2016. His current focus as a commissioner is on mental health resilience, land and wildlife preservation, and the transition to renewable energy.

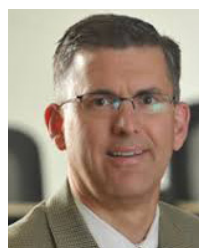

ROBERT J. VALUCK, PhD, RPh, FNAP, is a professor in the Departments of Clinical Pharmacy, Epidemiology, and Family Medicine at the University of Colorado Schools of Pharmacy, Public Health, and Medicine at the Anschutz Medical Campus in Aurora. Dr.

Valuck is Director of the Colorado Consortium for Prescription Drug Abuse Prevention, created by Gov. John Hickenlooper to address the prescription drug abuse problem with a collaborative, statewide approach. The Consortium has evolved over the past four years to include nine work groups, with more than 400 members across the state, focusing on key areas relating to education, prevention, intervention, treatment and recovery.

HOT ISSUES FURTHER READING: **SUBSTANCE USE**

Nine hundred and seventy-four Coloradans died of drug overdoses in 2018 — the second highest total on record behind the 1,012 deaths recorded in 2017. There were 349 deaths involving prescription opioids.

Learn more here: colo.health/SubstanceUse2018

SPEAKERS AND PANELISTS (CONT.)

THE COST OF DOING BUSINESS: WHAT EMPLOYERS CAN DO TO ADDRESS RISING HEALTH CARE COSTS



TAMARA POGUE became the CEO of Peak Health Alliance in July 2019. Prior to that, she was the executive director of the Family and Intercultural Resource Center, where she worked on issues related to health care and the social

determinants of health care. She brings more than a decade of nonprofit, government, and political management experience. She has served as staff to Maine Governor John Baldacci, Former Vermont Governor Howard Dean and the Maine Senate. Prior to moving to Summit County, Pogue served as deputy director of Wisconsin Citizen Action, Wisconsin's largest public advocacy nonprofit organization. She holds a master's degree in nonprofit management from Regis University.



LAURA GIOCOMO RIZZO is senior vice president of external affairs at the Denver Metro Chamber of Commerce, where she oversees marketing, communications, government and public affairs and events. She

worked in communications and marketing for then-Mayor John Hickenlooper, the Colorado Department of Higher Education, Centura Health, and SE2, a Denver-based communications consulting firm specializing in public issues. During her time with SE2, she managed strategic communications and brand development for health care, education and transportation clients, including the Colorado Hospital Association, Denver Public Schools and The Colorado Trust.



DAVE RESSLER, CEO of Aspen Valley Hospital, has 35 years of health care experience with 25 of those years as a hospital administrator, including 12 at Aspen Valley Hospital. He served as AVH's CEO from 2004-2013,

returning to the position in the fall 2016. In 2013, Ressler moved to Tucson, Arizona, where he was chief strategy officer and chief operating officer at Tucson Medical Center, a 600-bed tertiary hospital. Then, prior to returning to AVH, Ressler was the executive director of a newly formed management company, the Community Care Alliance, that formed two Accountable Care Organizations serving seniors in 14 rural communities in western Colorado and Washington State.

HOT ISSUES FURTHER READING: **HEALTH CARE COSTS**

Nearly one in five residents (18.1 percent) said they had problems paying medical bills in the past year. That's as high as this number has been since before major provisions of the Affordable Care Act took effect in 2014.

Learn more here: colo.health/CHAS



Lt. Gov. **DIANNE PRIMAVERA** is a leading patient advocate who has spent three decades fighting for every Coloradan's access to quality, affordable health care. She has fought cancer four times and survived. Her personal battle with cancer inspired her to make it her life's work to ensure every Coloradan has access to the health care they need when they need it.

In 1990, Primavera joined the Rocky Mountain Regional Brain Injury Center, where her work focused on helping individuals dealing with serious injuries recover and resume dignified, fulfilling lives. Since then, she's held prominent positions throughout the public and nonprofit sectors. In 2006, Primavera was elected to the first of four terms in the State Legislature, representing Broomfield, Superior, and parts of Erie. Most recently, she served as CEO of Susan G. Komen Colorado.



ANDREW ROMANOFF is a candidate for the U.S. Senate. As president and CEO of Mental Health Colorado, Romanoff led the fight for the prevention and treatment of mental health and substance use disorders. Among the results: pathbreaking programs for children and families and \$68 million per year in life-saving services for Coloradans in need.

Romanoff won four terms in the Colorado House of Representatives — including two terms as speaker of the House — and led the Democrats to their first majority in 30 years. He earned recognition from more than 50 state and national organizations as one of the most effective legislative leaders in America. Romanoff began his career at the Southern Poverty Law Center. His work there fueled a lifelong passion for justice — a cause he later championed at a state civil rights agency.

The Colorado Health Institute extended invitations to candidates and elected officials, including Attorney General Phil Weiser, Sen. Cory Gardner, former Gov. John Hickenlooper, a U.S. Senate candidate and presidential candidates Michael Bennet, Joe Biden, Cory Booker, Pete Buttigieg, Kamala Harris, Bernie Sanders, and Elizabeth Warren, who were either unable to attend or had not confirmed attendance at the time this program was printed.

CHI SPEAKERS



KARAM AHMAD, a policy analyst at the Colorado Health Institute, leads CHI's work on climate change and health and works on a variety of health policy issues from health information technology, behavioral health, veterans health, evaluation, and more. He joined CHI in 2017.



JEFF BONTRAGER, a director at the Colorado Health Institute, coordinates research related to health equity, coverage, the uninsured, access to care, and social factors. Bontrager develops and oversees many of CHI's program evaluation efforts, and is the principal investigator on the CHAS. He joined CHI in 2005.



ELI BOONE, a research analyst at the Colorado Health Institute, focuses on Medicaid innovation and coordinates the CHAS, the premier source of information on health insurance coverage, access to health care, and use of health care services. He joined CHI in February 2018.



ASHLIE BROWN, a director at the Colorado Health Institute, supports state and local partners who are undertaking complex system change. Brown focuses on health care delivery system and payment reform, as well as the data infrastructure needed to support reform efforts. She joined CHI in January 2016.



ALEX CALDWELL, a director at the Colorado Health Institute, researches behavioral health, access to specialty care, and other issues. Caldwell works closely with foundations, state agencies, and others to conduct evaluations, needs assessments, and strategic planning. She joined CHI in August 2016.



JOE HANEL, communications director at the Colorado Health Institute, helps ensure that CHI's research is relevant, useful, and easily understood by a broad audience. He worked 19 years as a journalist before joining CHI in May 2014.



JALYN INGALLS, a policy analyst at the Colorado Health Institute, focuses on behavioral health research and analysis. She has facilitated the process for behavioral health strategic plans at the state and local level, and has led evaluation efforts for innovative behavioral health programs. Additionally, she had reported on a variety of issues, including the overdose epidemic, parity laws, and policy considerations associated with e-cigarettes. She joined CHI in January 2018.



MICHELE LUECK, president and CEO of the Colorado Health Institute, consults with leading academic organizations, helps diverse groups achieve their strategic goals, and gives presentations around the state and country. In her 20-plus years of health and health care experience, she has held leadership roles in two other nonprofits, consulted with many more, and worked in account management in the private sector. She joined CHI in November 2010.



ALLIE MORGAN, a director at the Colorado Health Institute, manages legislative relations and provides research, presentations, and commentary on developments at the state Capitol. She also oversees CHI's annual research agenda and the Hot Issues in Health conference. She joined CHI in July 2014.



SARA SCHMITT, managing director of research, evaluation, and consulting at the Colorado Health Institute, supports the development and execution of CHI's research, evaluation, and consulting portfolios. She also directs multisector collaborations working to advance health in the metro Denver area. She joined CHI in January 2012.



ROMANA HASNAIN-WYNIA, MS, PhD, chair of the CHI Board of Trustees, serves as the chief research officer at Denver Health, where she oversees research and sponsored programs through the Office of Research and represents research interests as a member of the executive leadership team. Prior to joining Denver Health, she was the director of the Addressing Disparities program at the Patient-Centered Outcomes Research Institute, where she provided strategic oversight and leadership related to national funding priorities.

ORGANIZATIONS REPRESENTED BY ATTENDEES

5280 Strategies
AgoHealth
AHIP
Alzheimer's Association of Colorado
Amgen
Aponte & Busam
Arapahoe County Department of Human Services
Aspen Valley Hospital
Aurora Health Alliance
Baskett
Beacon Health Options
Benefits in Action
Boulder County
Boulder County Area Agency on Aging
Boulder Valley Women's Health Center
Caring for Colorado Foundation
CCHA
Center for African American Health
Center for Health Progress
Centura Health
Children's Hospital Colorado
Chronic Care Collaborative
Clear Creek County
Clinica Colorado
Clinica Family Health
CLLARO
Colorado Access
Colorado Affiliate of ACNM
Colorado Association of Health Plans
Colorado Association of Local Public Health Officials
Colorado Center for Nursing Excellence
Colorado Children's Campaign
Colorado Children's Healthcare Access Program
Colorado Commission on Family Medicine
Colorado Community Health Network
Colorado Department of Health Care Policy and Financing
Colorado Department of Public Health and Environment
Colorado Department of Regulatory Agencies
Colorado Division of Insurance
Colorado Health Facilities Authority

Colorado Hospital Association
Colorado Legislative Council
Colorado Medical Society
Colorado Office of Behavioral Health
Colorado Office of Early Childhood
Colorado Rural Health Center
Colorado Safety Net Collaborative
Colorado School of Public Health
Colorado Springs Health Foundation
Colorado State House
Colorado State Senate
Community Health Partnership
Connect For Health Colorado
COPIC
CORHIO
Covering Kids and Families - CCHN
CPEP
CVS Health
Delta Dental of Colorado
Denver Health & Hospital Authority
Denver Metro Chamber of Commerce
Denver Public Health
Disability Law Colorado
Doctors Care
Dolores County
Earthlinks
El Paso County Public Health
Every Child Pediatrics
Foothills Medical Society
Frontline Public Affairs
Garfield County Public Health
GERICK
Governor's Office
HCA/HealthONEHealth
District of Northern Larimer County
Healthier Colorado
HRSA
Immunize Colorado
Inner City Health Center
Issues Research, Inc.
Jefferson Center for Mental Health
Johnson and Johnson
JSI Research & Training Institute, Inc.
Kaiser Permanente
LeadingAge Colorado
Lindsay3, LLC
Liver Health Connection

Mental Health Center of Denver
Mesa County Public Health
Metropolitan State University of Denver
Mile High Health Alliance
Monument Health
NGA Health
Northeast Colorado Health Department
Office of Sen. Cory Gardner
Peak Health Alliance
Physician Health Partners
Pinnacol
Pitkin County Public Health
Polsinelli
Project Angel Heart
Public Consulting Group
Quality Health Network
San Juan Basin Public Health
SCL Health
Segue Consulting
Steadman Group
Stride Community Health Center
Summit Community Care Clinic
Summit County Government
Sunrise Community Health
The Denver Foundation
The Equitas Project
The Flahive Group LLC
The Piton Foundation
Transformative Training
Tri-County Health Department
United Urology
University of Colorado
University of Colorado Anschutz Medical Campus
University of Colorado College of Nursing
University of Colorado Colorado Springs
University of Colorado School of Dental Medicine
University of Michigan
Valley Health Alliance
Western Healthcare Alliance
ZOMA Foundation

ABOUT OUR CHARITY DONATION



In lieu of giving out pens, tote bags, or stress balls, the Colorado Health Institute has made a donation to Share in appreciation of support they have provided to our CHI family this year. We invite you to learn more about this deserving organization by visiting nationalshare.org.

We are grateful for their work.



COLORADO HEALTH INSTITUTE

The Colorado Health Institute is a trusted source of independent and objective health information, data, and analysis for the state's health care leaders. CHI's work is made possible by generous supporters who see the value of independent, evidence-based analysis. Those supporters can be found on our website coloradohealthinstitute.org/about-us.

303 E. 17th Ave., Suite 930, Denver, CO 80203
303.831.4200 • coloradohealthinstitute.org